

# Domekt R 400 V

Maximal air flow, m <sup>3</sup> /h	381
Maximal air flow, l/s	106
Unit weight, kg	49
Supply voltage, V	1~230
Maximal operating current, A	HE6,5
Thermal efficiency of heat recovery, %	85
Reference flow rate, m <sup>3</sup> /s	0,074
Reference pressure difference, Pa	50
SPI, W/(m <sup>3</sup> /h)	0,3
Filters dimensions BxHxL, mm	428x231x46
Electric power input of the fan drive at reference flow rate, W	55
Electric power input of the fan drive at maximum flow rate, W	126
Electric air heater capacity, kW / Δt, °C	1 / 10,4
Maintenance space, mm	600

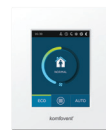

C6.1



C6.2

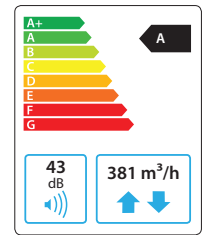

## Acoustic data

A-weighted sound power level  $L_{WAr}$  dB(A) at reference flow rate

Supply inlet	55
Supply outlet	68
Exhaust inlet	55
Exhaust outlet	69
Casing	43

A-weighted sound pressure level  $L_{pAr}$  dB(A)

10 m<sup>2</sup> normally isolated room, distance from casing – 3 m.

Surroundings	33
--------------	----

## Temperature efficiency

Outside temperature, °C	Winter					Summer		
	-23	-15	-10	-5	0	25	30	35
After heat exchanger, °C	15,2	16,4	17,2	17,9	18,7	22,5	23,2	24

indoor +22°C, 20 % RH

Shown as left (L1)

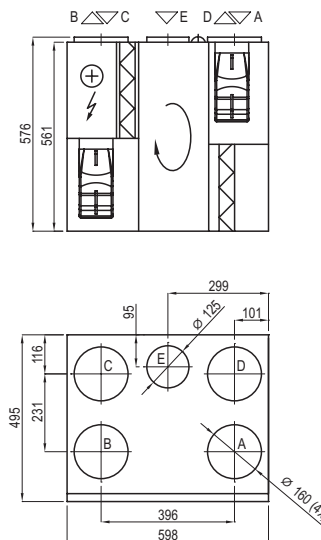

Shown as right (R1)

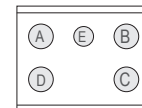

- A outdoor intake
- B supply air
- C extract indoor
- D exhaust air
- E additional extraction connection (by-pass – extraction without heat recovery)

## Performance

Unit with standard equipment

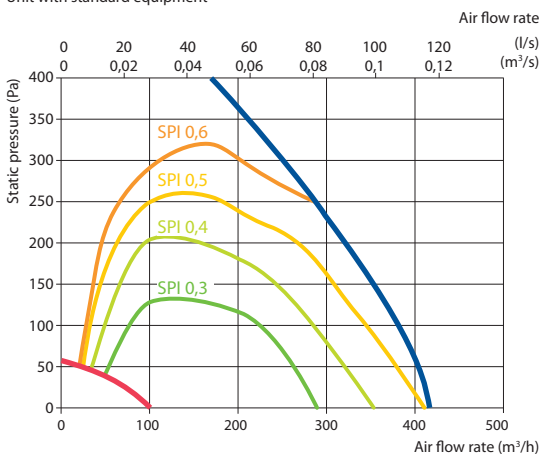

## Accessories (p. 123)

Closing damper	AGUJ-M-160+LF230/LM230
Silencer	A/D AGS-160-50-600-M B/C AGS-160-50-900-M
Water heater	DH-160
PPU	PPU-HW-3R-15-0,4-W1
2-way valve (water heater)	VVP47.10-0,4

Water cooler	DCW-0,4-3
2-way valve (water cooler)	VVP47.10-1,6
Outdoor grill	LD-160
DX cooler	DCF-0,4-3
Cooling unit	MOU-12HFN8+KA8140